

# FT 292

## PRESSURE GAUGE ISOLATOR VALVE

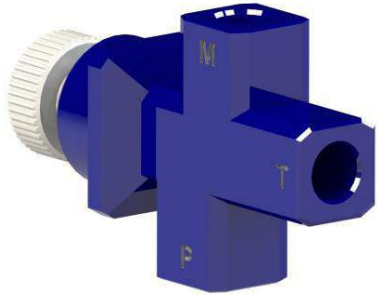

### 1 – OPERATING PRINCIPLES

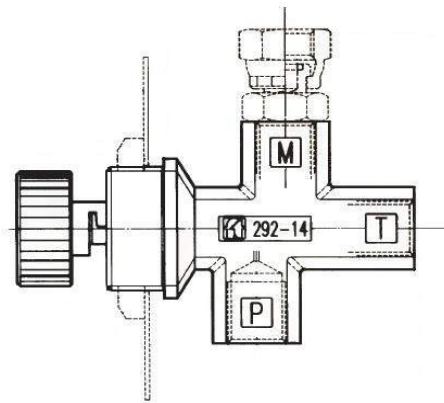

- The FT 292 pressure gauge isolator push-button valves are usually used to protect the manometer, and have double function: damping pressure waves during the opening and complete isolation of the manometer.
- When pushing the button, a reading is obtained. When releasing the button, it blocks the flow rate to the manometer with the automatic draining of residual pressure. The button can be locked to give a continuous reading.
- Installations for assembly in panel or in line.
- Assembly fixers in panel are supplied with the valve.
- They can be used to work at pressures of up to 400 bar.

### 2 – HYDRAULIC SYMBOL

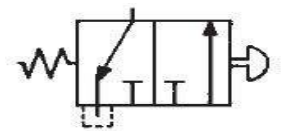

### 3 – MATERIALS

<b>Body</b>	9 S Mn Pb 23 – UNI 5105 – Forged
<b>Cursor</b>	35 S Mn Pb 10 – UNI 5105 – Heat treated
<b>O'ring</b>	Nitrile
<b>Push-button</b>	Nylon 66
<b>Weight</b>	0.265 kg

**4 – IDENTIFICATION**

**FT 292 - 14 GT**

Pressure gauge isolator valve

Model:  
14

Accessory:  
GT = With nut and plate for assembly in panel

**5 – DIMENSIONS**

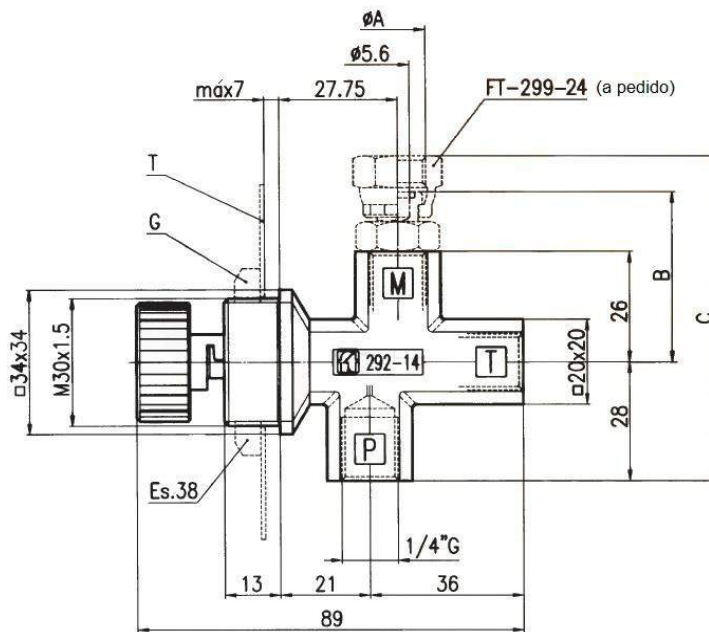

Model	ØA	B	C
14	1/4" G	45	80

- 1 – HT reserves the right to change informations of this catalog without previous warning.
- 2 – Copy is forbidden.
- 3 – If not indicated, dimensions in millimeters.

